

## SERVICE INFORMATION — DO NOT REMOVE

### IMPORTANT SAFETY NOTICE

THIS INFORMATION IS INTENDED FOR USE BY INDIVIDUALS POSSESSING ADEQUATE BACKGROUNDS OF ELECTRICAL, ELECTRONIC AND MECHANICAL EXPERIENCE. ANY ATTEMPT TO REPAIR A MAJOR APPLIANCE MAY RESULT IN PERSONAL INJURY AND PROPERTY DAMAGE. THE MANUFACTURER OR SELLER CANNOT BE RESPONSIBLE FOR THE INTERPRETATION OF THIS INFORMATION, NOR CAN IT ASSUME ANY LIABILITY IN CONNECTION WITH ITS USE.

### DISCONNECT POWER BEFORE SERVICING

**IMPORTANT – RECONNECT ALL GROUNDING DEVICES** IF GROUNDING WIRES, SCREWS, STRAPS, CLIPS, NUTS OR WASHERS USED TO COMPLETE A PATH TO GROUND ARE REMOVED FOR SERVICE, THEY MUST BE RETURNED TO THEIR ORIGINAL POSITION AND PROPERLY FASTENED.

### WARNING



Certain internal parts are intentionally not grounded and may present a risk of electric shock only during servicing. Service personnel – **DO NOT** contact the following parts while the appliance is energized: **water valve, main pump, drain pump and active vent motor (if present).**

### WASHABILITY COMPLAINTS

**Hot Water** – Ample supply of water at 120°F minimum temperature is necessary. Do not use dishwasher soon after using clothes washer or filling bathtub.

**Loading** – Consult Owner's Manual on loading procedures.

**Amount of Water** – Make sure dishwasher is level. Check water level, allowing dishwasher to fill normally for first fill. The water level should be to the center of the bottom of the float dome. If water level is low, check for clogged screen in water valve and check float switch.

**Detergent Module Leakage** – Some moisture in cup is normal. Detergent must not be soaking wet, oozing out and down the inner door panel. If a leak is detected, check detergent module door lid, latch operation, and gasket seal.

**Proper Amount of Detergent** – Use full detergent cup of fresh detergent in hard water. Use only enough detergent to get good wash performance in soft water.

**Rinse Agent** – Use rinse agent if spotting is a problem.

**Water Valve** – Check valve for intermittent operation. Valve coil can be direct tested. Allow to heat normally, then check to see if coil opens.

**Spray Arm** – Check to be sure spray arm spins freely and jets are not clogged.

**Float Switch** – Manually open the switch several times by lifting the float stem and ensure the switch closes. If not, replace the switch.

### FILTER AND DRAIN SYSTEM

#### Will Not Pump Out

1. Enter service mode and check drain pump operation (see service mode).
2. Check cover inlet (Figure 3) in the bottom of the tub. Make sure that it is clear of food particles.
3. Check for blocked or partially blocked drain line and air gap.
4. Check routing of drain hose system. It must be free from kinks.
5. Remove lower spray arm (Figure 3).
6. Remove main conduit mounting screw (Figure 3).
7. Lift main conduit tab, pull and rotate main conduit out of hub (Figure 3).
8. Remove the cover inlet, check sump and drain outlet (Figure 3). It may be blocked by a toothpick or other object.
9. Check drain pump valve (Figure 1) for correct operation. Water should flow only from the pump to the high drain loop.
10. Drain line check valve (Figure 1) must pass water in the drain line direction only.

### MOTOR-PUMP MECHANISM

#### Motor Stalled-Hums

1. Disconnect Power. Try to turn motor shaft clockwise to determine if seal is stuck and can be broken loose. If motor shaft cannot be turned, cutter blade may be bound up. Proceed to step 2.
2. On inside of dishwasher, remove the cover inlet (Figure 3) and reach down into the sump (Figure 1). Check for blockages such as bone, wire ties, etc. If it contains debris, clean thoroughly. If motor shaft cannot be turned, remove mechanism.

#### To Remove Motor-Pump Mechanism:

1. Remove cover inlet (Figure 3). With syringe, remove all water from sump (Figure 3).
2. Loosen main pump clamp and pump connector clamp (Figure 1).
3. Remove hanger that holds motor to tub frame (Figure 1).
4. Motor-pump mechanism can now be removed from under dishwasher.

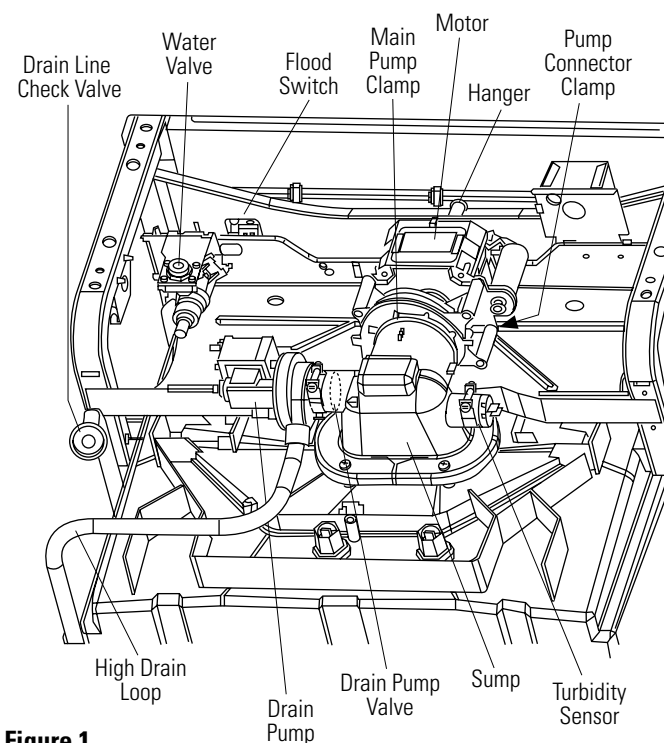

Figure 1

### TO SERVICE WASH ARM ASSEMBLIES:

#### Check Wash Arms

1. Check holes in spray arm for bits of china, seeds and other foreign matter.
2. Check spray arms for rotation.

#### To Disassemble Mid-Level Arm (Figure 2):

1. Pull upper rack all the way out.
  2. Remove nut on bottom of mid arm. This will allow the mid arm and bearing to be removed.
  3. To remove conduit, remove screw (some models) from hub. Press tab on side of mid bracket to release the hub and mid conduit.
  4. To reinstall arm, reverse procedure.
- NOTE:** Mid arm to be installed with spray jets facing the upper rack. Bearing to be placed between nut and bottom of mid arm.

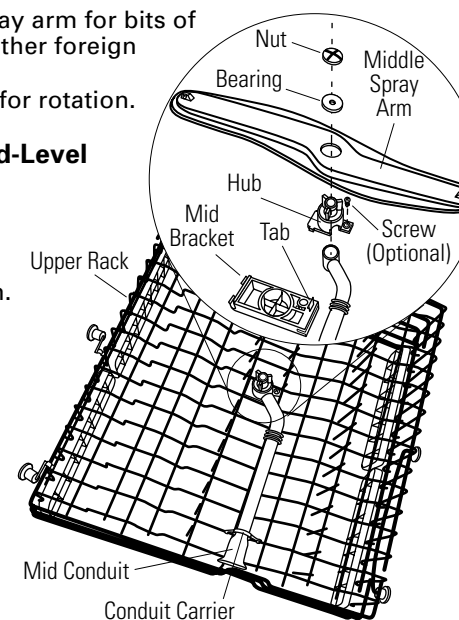

Figure 2

#### To Remove Lower Arm and Fine Filter Assembly (Figure 3):

1. Remove lower rack from dishwasher.
  2. Gently lift and rotate lower spray arm counter clockwise to remove.
  3. Rotate nut hub counterclockwise to remove. Gently lift fine filter assembly up. Remove fine filter drain from sump.
  4. Clean fine filter screen if soil is present.
  5. To reinstall fine filter and lower spray arm reverse procedure.
- NOTE:** When installing fine filter make sure the drain port of the filter is engaged with the drain for the fine filter.

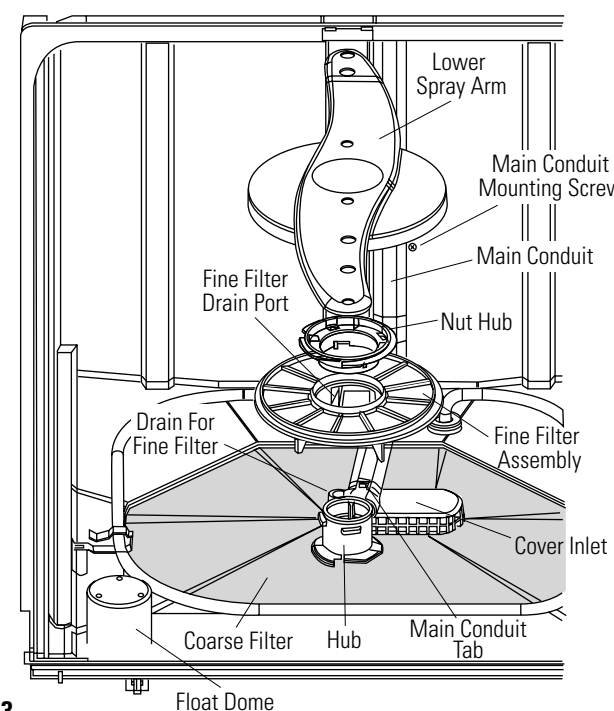

Figure 3

### CALROD® HEATING ELEMENT

#### To Remove Heating Element (Figure 4):

1. Disconnect Power and remove wire leads from heating element.
2. Unscrew two heating element nuts.
3. Remove heating element supports.
4. Lift and remove heating element.

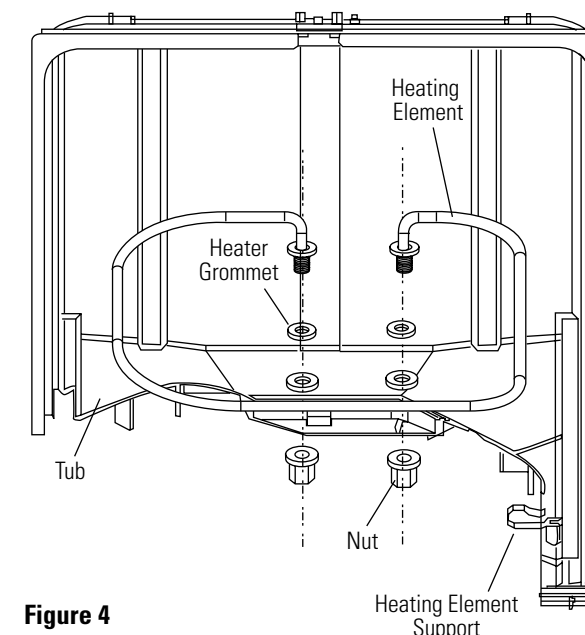

Figure 4

### DOOR COMPONENTS (Figure 5)

The door components are accessible by removing three screws from each side of inner door and two screws at the bottom of the door. Carefully separate the inner door panel from the outer door panel. Disconnect HMI and 3-digit connector to completely remove the outer door panel. The active vent flapper can be accessed by removing the screws on the fan housing. HMI must be reconnected prior to restoring power.

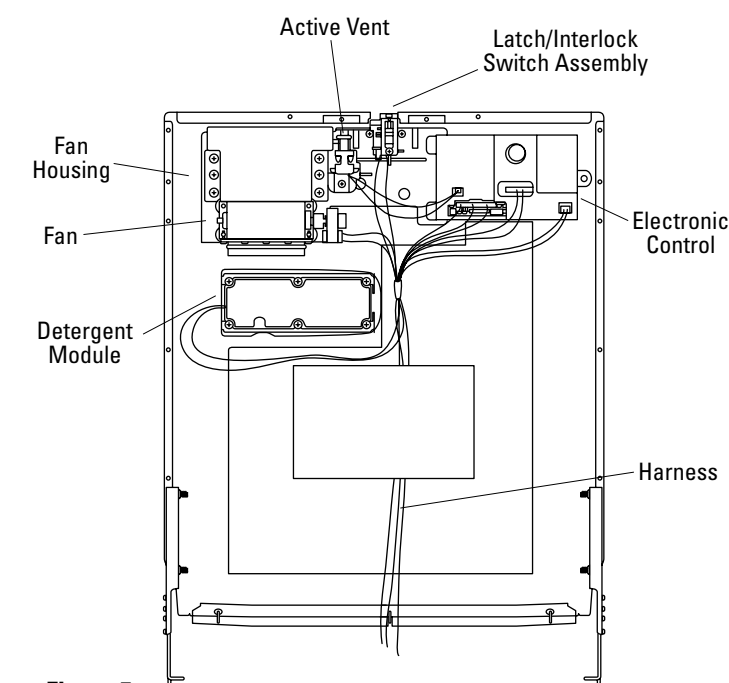

Figure 5

# 165D6290G035

FLASHING DISPLAY LIGHTS	
<b>Status Indicator Lights</b>	<b>What It Means</b>
<b>START/RESET</b>	Cycle has been interrupted by pressing the <b>START/RESET</b> keypad. Light will quit flashing after the dishwasher automatically drains out the water.

**THIS DISHWASHER IS PROGRAMMED WITH A SERVICE MODE TO AID THE TECHNICIAN IN TROUBLESHOOTING THE DISHWASHER. EACH COMPONENT MAY BE CYCLED TO DETECT IF IT IS FUNCTIONING CORRECTLY. COMPONENTS ARE CYCLED BY PRESSING KEYPADS TO THE RIGHT OR LEFT OF THE START/RESET KEYPAD. DETERMINE WHICH TYPE OF CONTROL PANEL IS PRESENT (6 OR 7 BUTTON) AND THEN USE THE CHART BELOW TO DETERMINE HOW TO CYCLE EACH COMPONENT.**

### 6-BUTTON TOP CONTROL PANEL



#### TO ENTER SERVICE MODE :

PRESS AND HOLD THE DOWN ARROW KEYPAD AND THEN PRESS THE HEATED DRY KEYPAD SIMULTANEOUSLY FOR 3 SECONDS.

### 7-BUTTON TOP CONTROL PANEL



#### TO EXIT SERVICE MODE :

PRESS THE START/RESET KEYPAD AT ANYTIME TO EXIT.

#### Service Mode Test Matrix\*

KeyPad			
Pad	Number of Buttons	Description	Time
<b>Keypads to the left of the Start/Reset keypads (Selections)</b>			
1L	6		
1L	7	Activates/Deactivates Heater & Fan	6 min.
(for 5 seconds)	6		
	7	Initiates Turbidity Sensor Calibration	variable
2L	6	Activates/Deactivates Water Valve	variable
	7	Not used for Service Mode	variable
3L	6	Activates/Deactivates Detergent Cup	variable
	7	Activates/Deactivates Water Valve	variable
4L	6	Activates/Deactivates Auxilliary Pump	variable
	7	Activates/Deactivates Detergent Cup	variable
5L	6	Activates/Deactivates Main Pump	variable
	7	Activates/Deactivates Auxilliary Pump	variable
6L	6	Not Present	N/A
	7	Activates/Deactivates Main Pump	variable
<b>START/RESET</b>		<b>Used to EXIT Service Mode</b>	

\*NOTE: Service mode may be used for 30 minutes maximum. After 30 minutes the service mode will automatically turn off.

NOTE: All components stay on until they are deactivated. Component may be deactivated by pressing the same keypad that was pressed to activate the component.

VOYANTS CLIGNOTANTS	
<b>Voyants d'état</b>	<b>Ce qu'il veut dire</b>
<b>START/RESET</b>	Le cycle a été interrompu en appuyant sur la touche <b>START/RESET</b> . Le voyant arrête de clignoter après la vidange automatique de l'eau.

**CE LAVE-VAISSELLE EST PROGRAMMÉ AVEC UN MODE DE SERVICE POUR AIDER LE TECHNICIEN PENDANT LE DÉPANNAGE. IL EST POSSIBLE DE METTRE EN MARCHÉ ET D'ARRÊTER CHAQUE ÉLÉMENT POUR DÉTERMINER S'IL FONCTIONNE CORRECTEMENT. POUR METTRE EN MARCHÉ ET ARRÊTER CHAQUE ÉLÉMENT, APPUYER SUR LES TOUCHES À DROITE OU À GAUCHE DE LA TOUCHE START/RESET. DÉTERMINER QUEL TYPE DE PANNEAU DE COMMANDE EST PRÉSENT (6 OU 7 TOUCHES) ET UTILISER LE TABLEAU PLUS BAS POUR DÉTERMINER COMMENT METTRE EN MARCHÉ ET ARRÊTER CHAQUE ÉLÉMENT.**

### PANNEAU DE COMMANDE SUPÉRIEUR À 6 TOUCHES

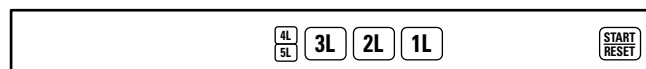

**POUR ENTRER EN MODE D'ENTRETIEN – APPUYER SUR LA TOUCHE DE FLÈCHE VERS LE BAS ET SIMULTANÉMENT APPUYER PENDANT 3 SECONDES SUR LA TOUCHE DE SÉCHAGE À CHAUD « HEATED DRY ».**

### PANNEAU DE COMMANDE SUPÉRIEUR À 7 TOUCHES

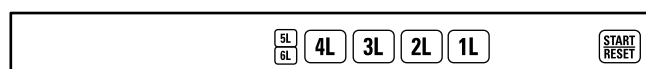

**POUR SORTIR DU MODE D'ENTRETIEN – APPUYER SUR LA TOUCHE START/RESET A N'IMPORTE QUEL MOMENT POUR SORTIR DU MODE.**

#### Matrice de test de mode d'entretien\*

Touche			
Clavier	Nombre de touches	Description	Durée
<b>Touches à gauche de la touche Start/Reset (Sélections)</b>			
1L	6		
1L	7	Active et désactive le chauffage et le ventilateur	6 min.
1L (pendant 5 secondes)	6		
	7	Lance l'étalonnage de la sonde de turbidité	variable
2L	6	Active et désactive le robinet d'eau	variable
	7	Pas utilisé pour le mode d'entretien	variable
3L	6	Active et désactive le distributeur de détergent	variable
	7	Active et désactive le robinet d'eau	variable
4L	6	Active et désactive la pompe auxiliaire	variable
	7	Active et désactive le distributeur de détergent	variable
5L	6	Active et désactive la pompe principale	variable
	7	Active et désactive la pompe auxiliaire	variable
6L	6	Pas présent	S/O
	7	Active et désactive la pomp principale	variable
<b>START/RESET</b>		<b>Utilisé pour SORTIR du mode d'entretien</b>	

\*REMARQUE – Il est possible d'utiliser le mode d'entretien pendant un maximum de 30 minutes. Après 30 minutes, le mode d'entretien s'arrête automatiquement.

REMARQUE – Tous les éléments restent en marche jusqu'à leur désactivation. Il est possible de désactiver un élément en appuyant sur la même touche que celle utilisée pour l'activer.

# 165D8000P001

**WARNING:**  
POWER **MUST** BE DISCONNECTED BEFORE SERVICING THE APPLIANCE.

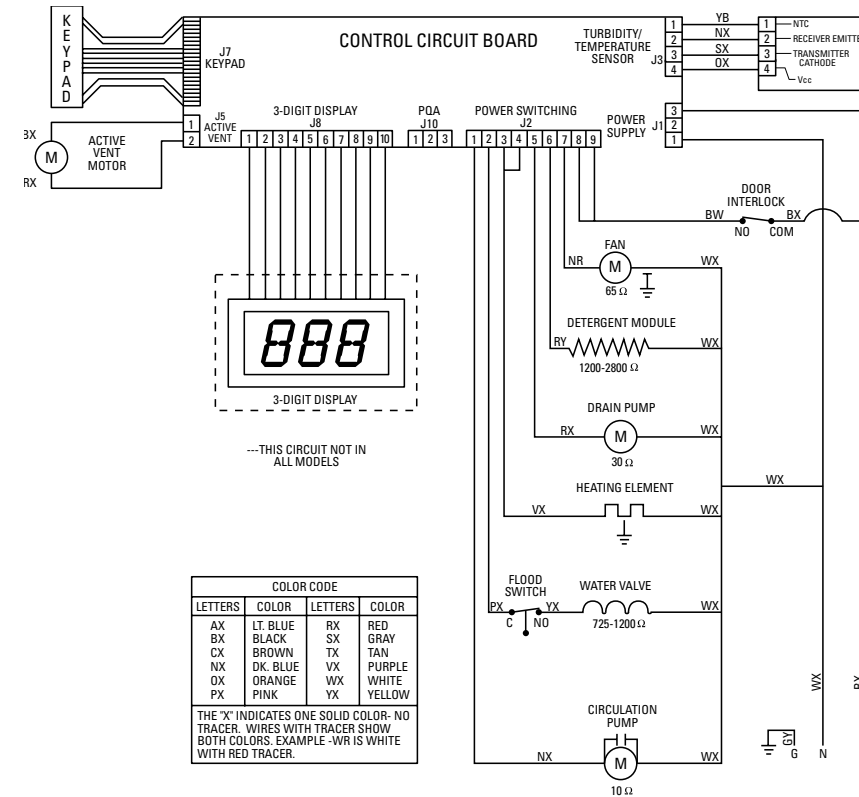

COLOR CODE			
LETTERS	COLOR	LETTERS	COLOR
AX	LT. BLUE	RX	RED GRAY
BX	BLACK	SX	TAN
CX	BROWN	TX	PURPLE
NX	DK. BLUE	VX	WHITE
OX	ORANGE	WX	YELLOW
PX	PINK	YX	

THE "X" INDICATES ONE SOLID COLOR. NO TRACER. WIRES WITH TRACER SHOW BOTH COLORS. EXAMPLE - WR IS WHITE WITH RED TRACER.

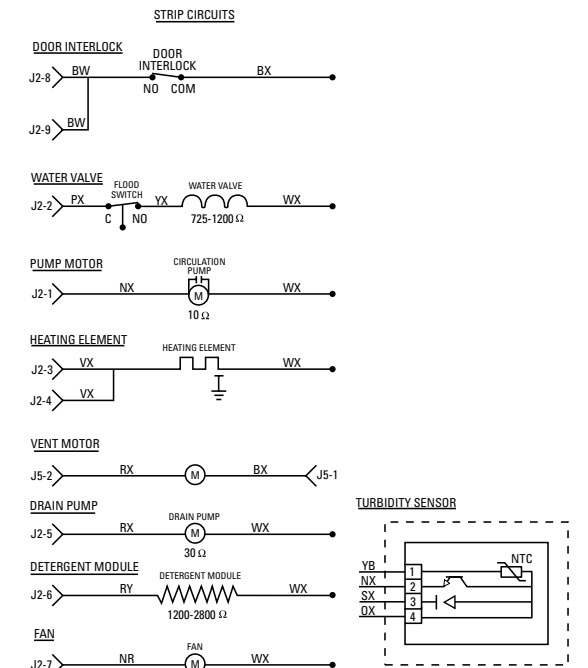

### ATTENTION

IL FAUT DEBRANCHER L'ALIMENTATION AVANT TOUTE INTERVENTION SUR L'APPAREIL.

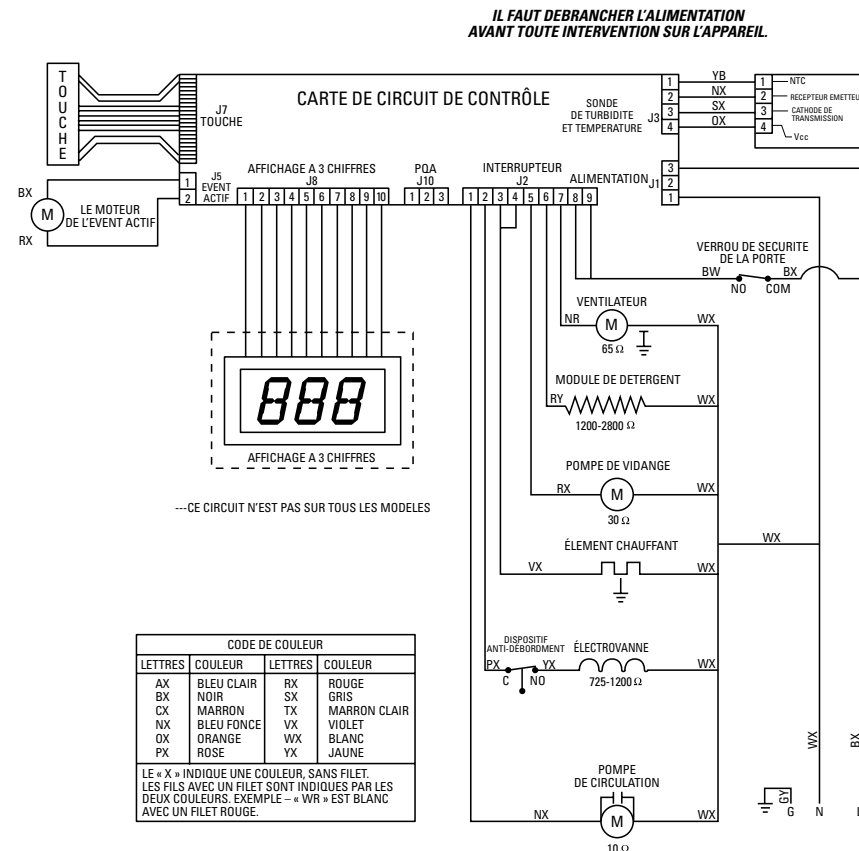

CODE DE COULEUR			
LETTRES	COULEUR	LETTRES	COULEUR
AX	BLEU CLAIR	RX	ROUGE
BX	NOIR	SX	GRIS
CX	MARRON	TX	MARRON CLAIR
NX	BLEU FONCE	VX	VIOLET
OX	ORANGE	WX	BLANC JAUNE
PX	ROSE	YX	

LE "X" = INDIQUE UNE COULEUR, SANS FILET. LES FILS AVEC UN FILET SONT INDICÉS PAR LES DEUX COULEURS. EXEMPLE - WR = EST BLANC AVEC UN FILET ROUGE.

